

更卓越的工作性能

More excellent running performance

SHANGHAI ZENITH COMPANY

*PFW series
impact crushers*

Shanghai Zenith Electric Power Equipment Co., Ltd.
Add: No.416 Jianye Road, South Jinqiao Area, Pudong
New Area, Shanghai, China
Tel: 0086-21-58386256 58386258
Fax: 0086-21-58385887
Zip: 201201
Http://www.zenithcrusher.com
E-mail: webmaster@zenithdream.com

上海西芝电力设备有限公司
地址: 上海浦东新区金桥南区建业路416号
电话: 021-58386256 58386258
传真: 021-58385887
邮编: 201201
网址: http://www.zenithcrusher.com
邮箱: webmaster@zenithdream.com



PFW系列反击破

PFW series impact crushers

More excellent running performance



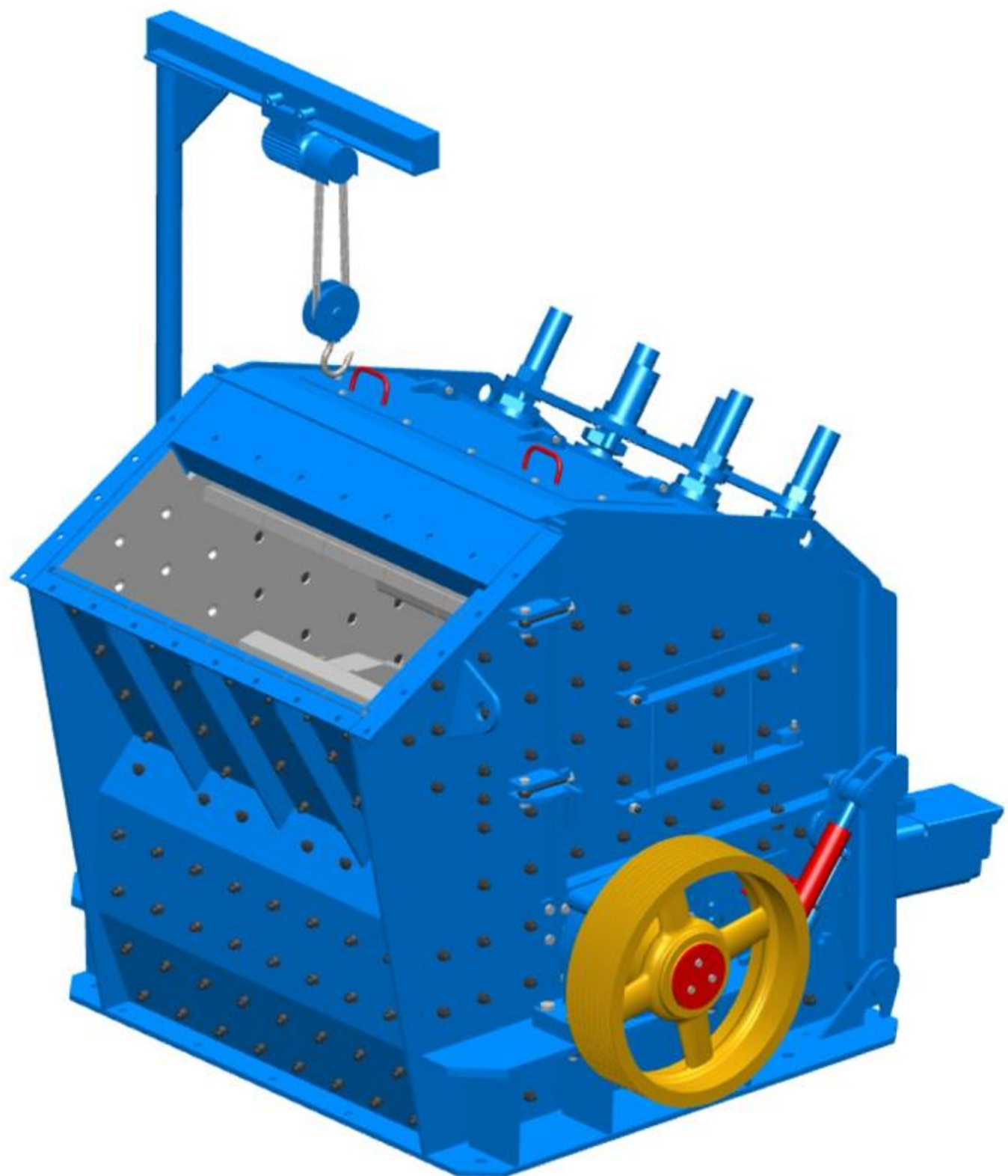

PFW系列反击破

PFW series impact crushers

产品简介：

PFW系列反击破是我公司在研究、设计和制造PF系列反击破的20多年经验的基础上，开发的最新型反击式破碎机。该系列反击式破碎机具有重型转子设计、独特的板锤锁紧系统、衬板内部可替换、维修方便等特点。因此，该系列反击破给客户提供一种低成本解决方案，性能突出，产品粒形好，单位运行成本低，适用物料范围广。

Product brief introduction:

PFW series impact crushers are the latest development of impact crusher based on zenith's more than 20 years experience and leading technology in PF impact crusher. PFW series impact crushers have the features of heavy duty rotor design, unique hammer locking system, interchangeable wearing parts, and easy maintenance. This series impact crushers provide customers low capital cost solutions, outstanding performance, good cubical shape, lowest operation cost per ton, and wide materials applications.

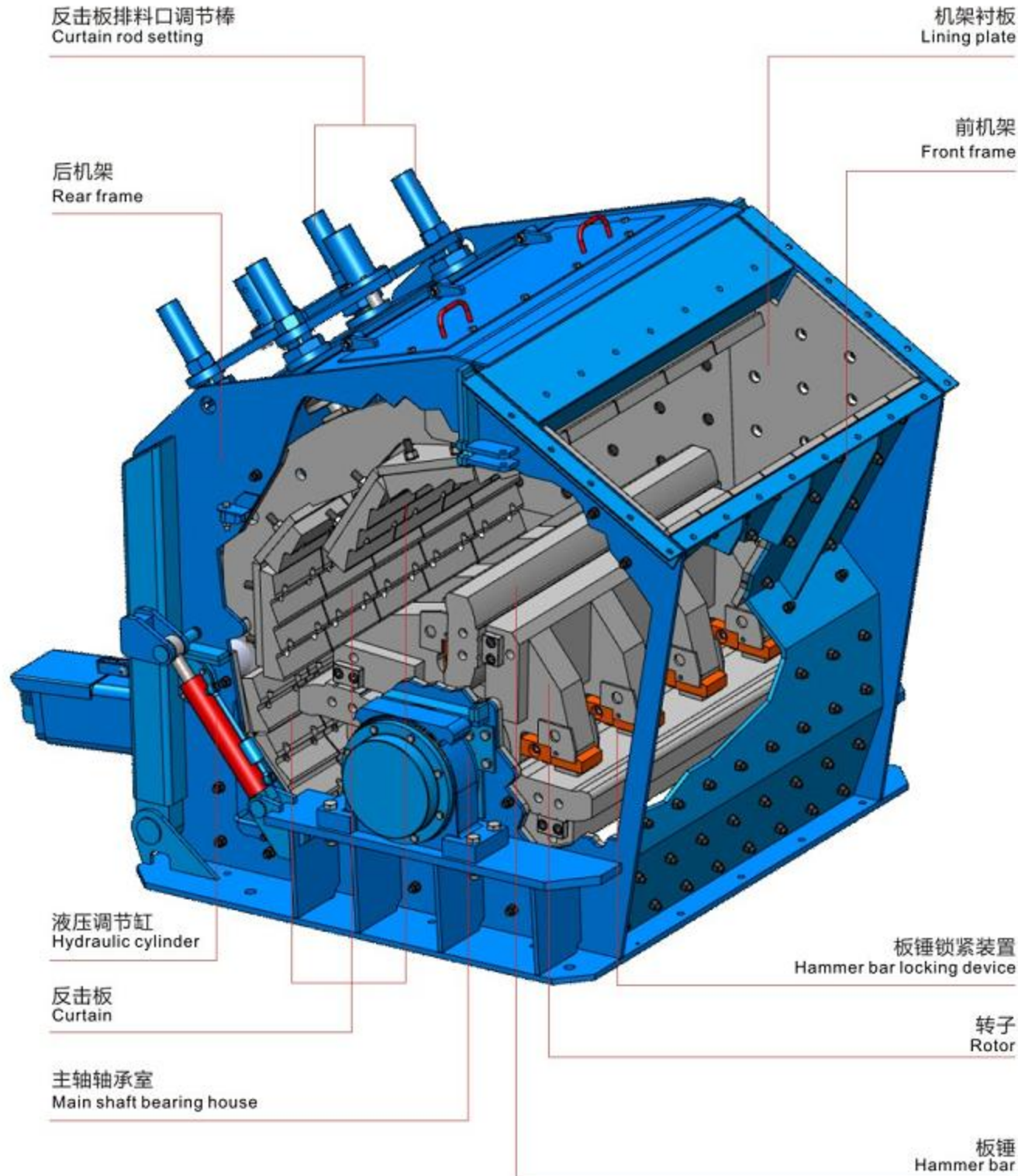

重型转子设计
Heavy duty rotor design

所有的PFW系列反击破都有一个为达到更高转动惯性、最佳破碎性能的重型转子。这种重型转子重量通常是竞争对手同等型号转子的1.5-2倍。正是这种重型转子设计确保了PFW系列反击破破碎物料时能产生最大的破碎惯性和反冲击力，达到最大的破碎比和最佳的产品粒形。

All pfw series impact crushers have a heavy duty and superior weight rotor, which deliver high inertia required for optimum crushing performance. These heavy duty rotors usually are 1.5-2 times heavier than the rotors of other competitor's comparable size, and ensure maximum inertia and superior impact forces, resulting in optimum reduction while maintaining cubical product shape.

独特的板锤锁紧装置
unique hammer locking device

板锤锁紧楔块同时从横向和纵向紧固住板锤，板锤的安装和更换非常简单快捷。

Hammer locking wedges fix the hammers both vertically and horizontally. It is very easy and quick to fit or remove the hammer. The rear of the hammer locks easily along the whole length of the backing plate and hammer, give solid abutment positioning and maintaining rigidity during operation.

衬板可内部调整更换
interchangeable liners

一般情况下，反击破在使用一段时间后，其不同位置衬板的磨损情况是不一样的。所有PFW系列反击破的衬板都是可以在机器内部进行调整更换的，这样就可以保证易损件最大程度的利用率，进一步降低设备的运行成本。

In a crusher, liners are not worn out at the same rate. All liners in PFW series impact crusher can be interchanged to compensate for areas with unequal wearing. This results in maximum utilization of wearing parts and further reduces operating costs.

初级破碎和二级破碎两用
flexible application in primary and secondary crushing

PFW系列反击式破碎机即可作为初级破碎机使用（P型，具有两个反击架），也可作为二级破碎机使用（S型，具有三个反击架）。P型具有比较高的破碎腔，可以接受更大的进料粒度；S型具有第三个可调节的反击架，破碎比更大，产品中细骨料含量更高。

PFW series impact crusher can be used both as primary crusher (P type, with two break curtain) and secondary crusher (S type, with three break curtain). P type has higher crushing chamber and accept bigger feeding size. S type has the third adjustable break curtain, gives higher reduction ratio and finer fraction sizes.

操作简单，维护方便
easy operation and simple maintenance

转子和反击架的间距，反击破上盖的启闭都是由液压系统完成。机器自带的吊装装置（可选）可以在更换配件、维修保养时带来巨大的便利。

Both the distance between rotor and breaking curtain and the opening or closing the crusher shell are done by hydraulic system. One lifting device(optional) is available for changing spare parts and maintenance.

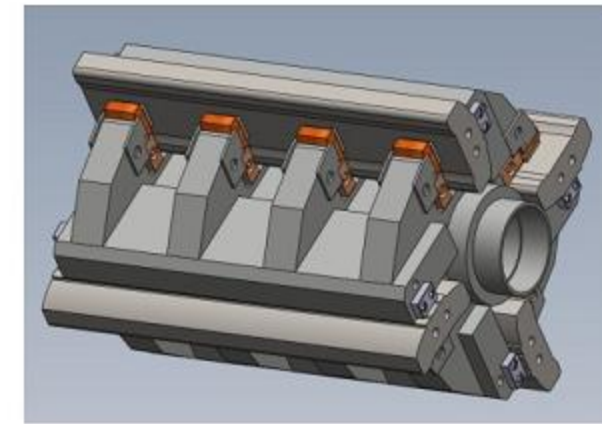

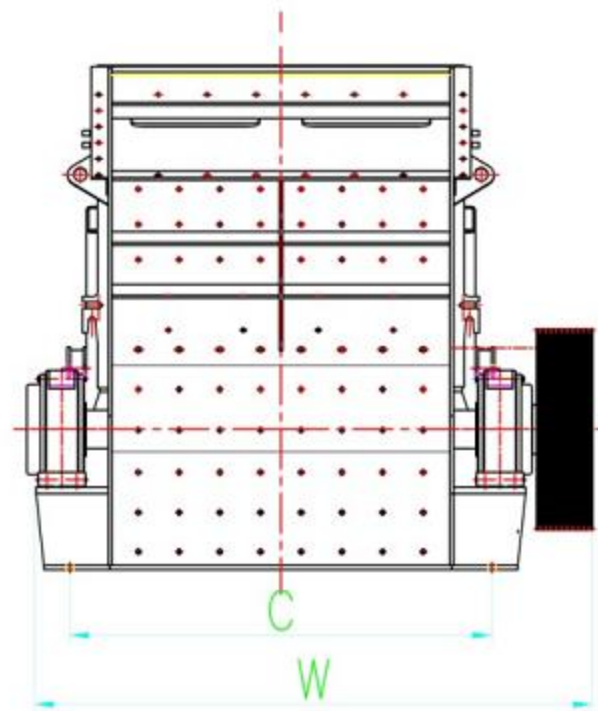
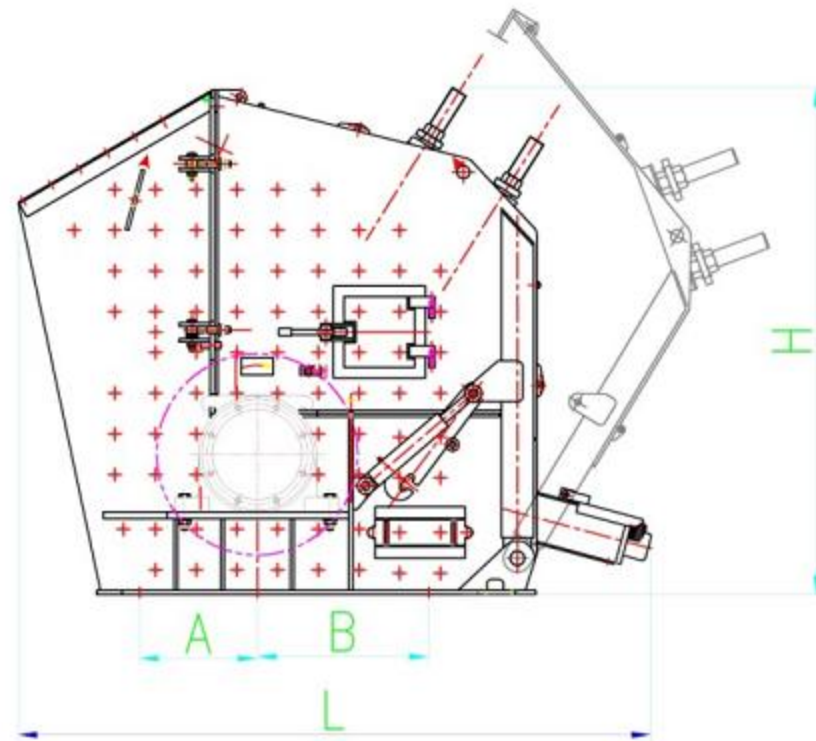

型号 Model	L	W	H	A	B	C	L1	W1	H1	A1	B1	C1
PFW1210	2550	1870	2100	600	650	1352	2400	1870	2550	600	650	1352
PFW1214	2550	2310	2100	600	650	1792	2400	2310	2550	600	650	1792
PFW1315	2960	2570	2380	550	800	1972	2700	2570	2800	550	800	1972
PFW1318	2960	2870	2380	550	800	2172	2700	2870	2800	550	800	2172

产品粒度曲线 Production curves

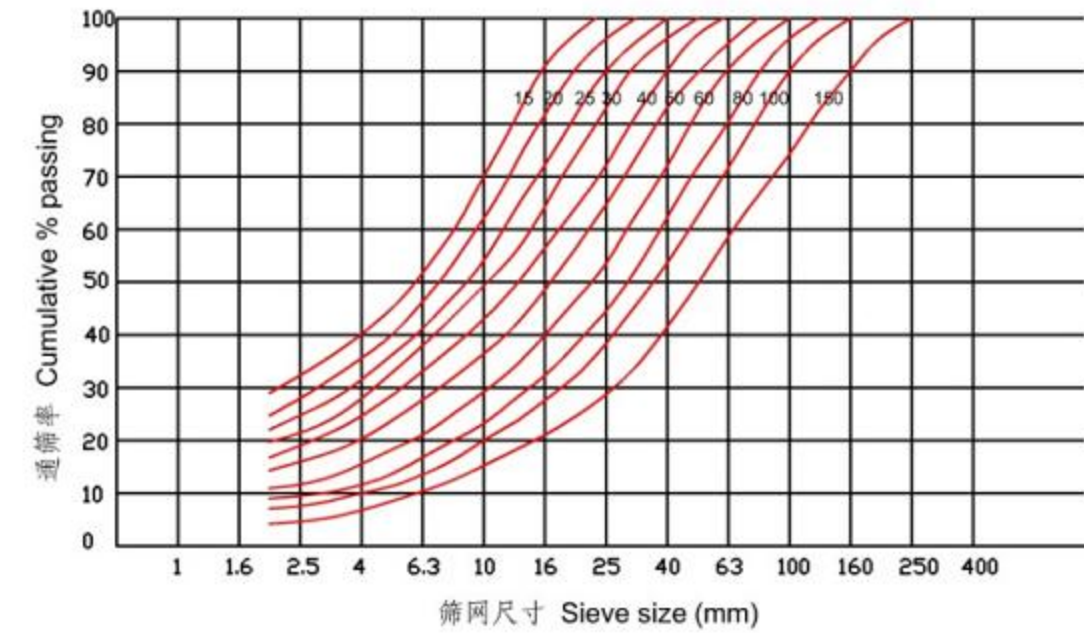

主要技术参数 Main technical data S型

型号 Model	规格 Model	进料口尺寸 (mm)	最大进料粒度 (mm)	生产能力 (t/h)	装机功率 (kw)	重量 Weight (t)	外形尺寸 Overall dimension (mm)
PFW1210III	Φ1150×960	570×990	250	70-120	90-110	15.0	2550×1870×2100
PFW1214III	Φ1150×1400	570×1430	250	90-170	132-160	19.0	2550×2310×2100
PFW1315III	Φ1300×1500	625×1530	300	180-270	160-200	25.0	2960×2570×2380
PFW1318III	Φ1300×1800	625×1830	300	220-300	200-250	30.0	2960×2870×2380

主要技术参数 Main technical data P型

型号 Model	规格 Model	进料口尺寸 (mm)	最大进料粒度 (mm)	生产能力 (t/h)	装机功率 (kw)	重量 Weight (t)	外形尺寸 Overall dimension (mm)
PFW1210III	Φ1150×960	1100×1030	400	90-160	90-110	17.0	2400×1870×2550
PFW1214III	Φ1150×1400	1100×1430	500	130-200	132-160	22.0	2400×2310×2550
PFW1315III	Φ1300×1500	1200×1530	600	180-320	160-200	29.0	2700×2570×2800
PFW1318III	Φ1300×1800	1200×1830	700	240-400	200-250	34.0	2700×2870×2800